

# Size 11 Hybrid stepping motor

## Features:

- High Torque
- Light weight
- Compact size
- High accuracy
- Step Angle 1,8°

## Options:

- Custom wires/ Connector.
- Custom winding.
- Special shape shaft (flat)
- Special bearing



Motor data		
Motor order number	1554-MY3002-01	1554-MY5002-01
Step accuracy	5%	5%
Phase current	0,95 Amp	0,95 Amp
Phase resistance	3,4 Ohm	4,6 Ohm
Phase Inductance	1,6 mH	2,3 mH
Holding Torque	70 mNm	90 mNm
Detent Torque	5 mNm	8 mNm
Rotor Inertia	12 gm-cm2	18 gm-cm2
Weight	140 G approx.	200 G approx
Insulation class	B	B
Temperature rise	80 ° C	80 ° C
Number of leads	6	6
Length	39,5 mm	50,3 mm
Radial play at 450 g	0,02 mm	0,02 mm
End play	0,08 mm	0,08 mm
Insulation resistance at 500 Vdc	Minimum 100 Ohm	Minimum 100 Ohm

## Dimensional drawing

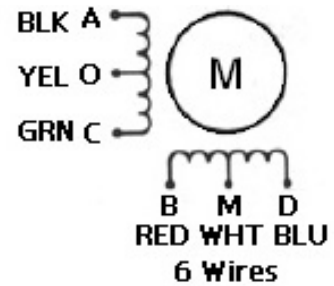
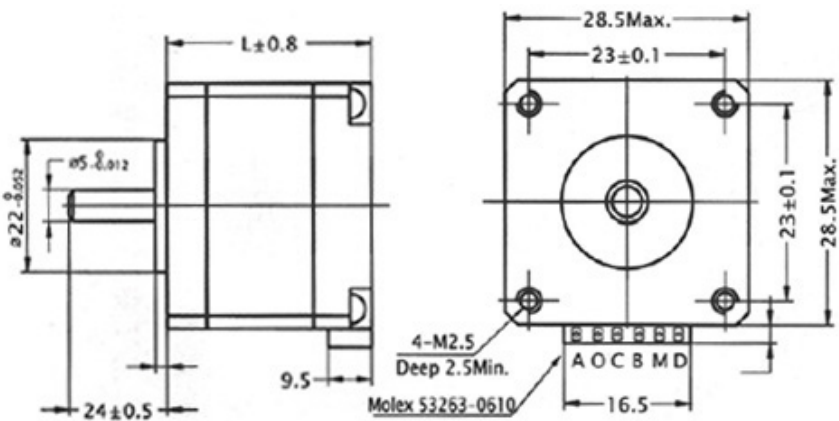

## Performance curve

